

BEETLE KILL SIDING INSTALLATION

SIGNATURE & SUMMIT SERIES SHEDS

v1 - MARCH 1, 2016

PLEASE



**READ THIS ENTIRE GUIDE
CAREFULLY PRIOR TO
STARTING INSTALLATION**

BEFORE PROCEEDING ENSURE:

**ALL WALLS ARE LEVEL, PLUMB, AND SQUARE.
ALL DOORS ARE INSTALLED PROPERLY.**

CALL US WITH QUESTIONS!

1-888-900-3933

TABLE OF CONTENTS:

METAL TRIM AND FLASHING OVERVIEW	0.2
DRIP EDGE INSTALLATION	1-2
DOOR CASING INSTALLATION	3-4
CORNER CAP INSTALLATION	4
BEETLE KILL SIDING INSTALLATION	
- STANDARD INSTALLATION ON WALLS	5-9
- INSTALLING AROUND DOORS	10-11
- INSTALLING AROUND WINDOWS	12

METAL TRIM AND FLASHING KEY:

B

2x4 FRAMING CORNER
CAP

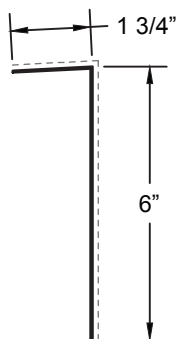

H

2x6 FRAMING CORNER
CAP

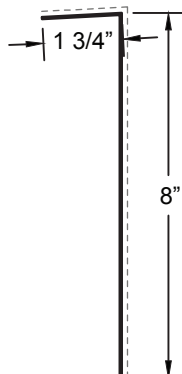

C

SIGNATURE & SUMMIT
BASE DRIP EDGE

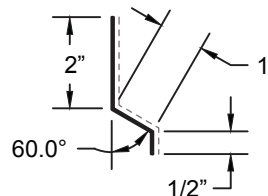

N

BEETLE KILL
Z-FLASHING

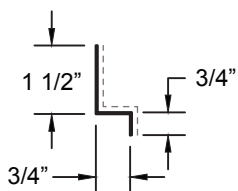

O

BEETLE KILL
J-CHANNEL

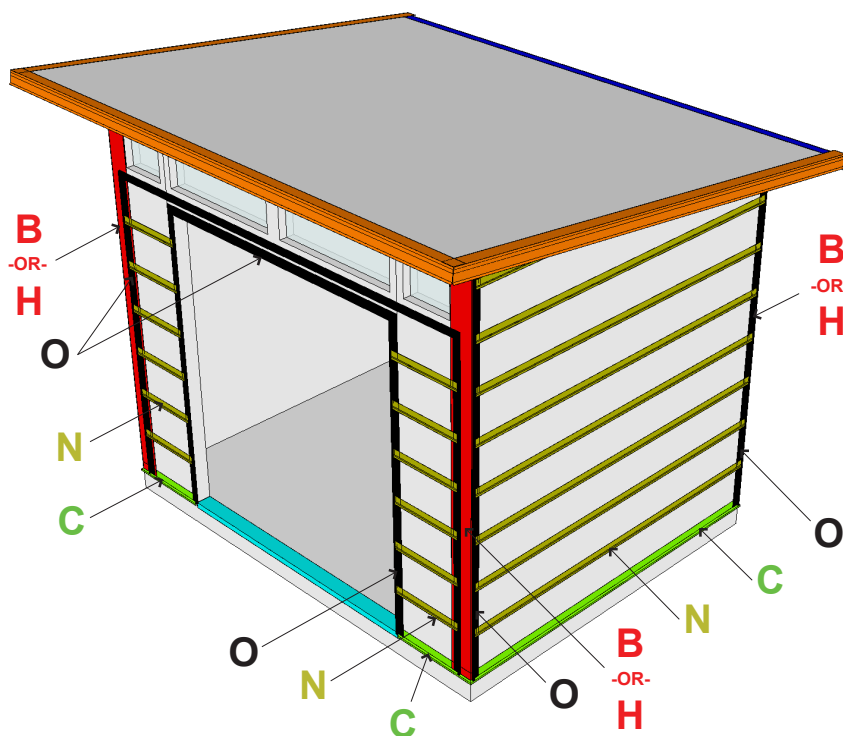
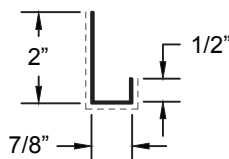

Fig 1a:



ENSURE THAT ALL OF THE STEPS IN THE BUILDING SHELL INSTALLATION GUIDE ARE COMPLETE AND THE DOOR(S) ARE INSTALLED PRIOR TO STARTING THE SIDING INSTALLATION.

CALL US WITH ANY QUESTIONS: 1-888-900-3933

Fig 1b:

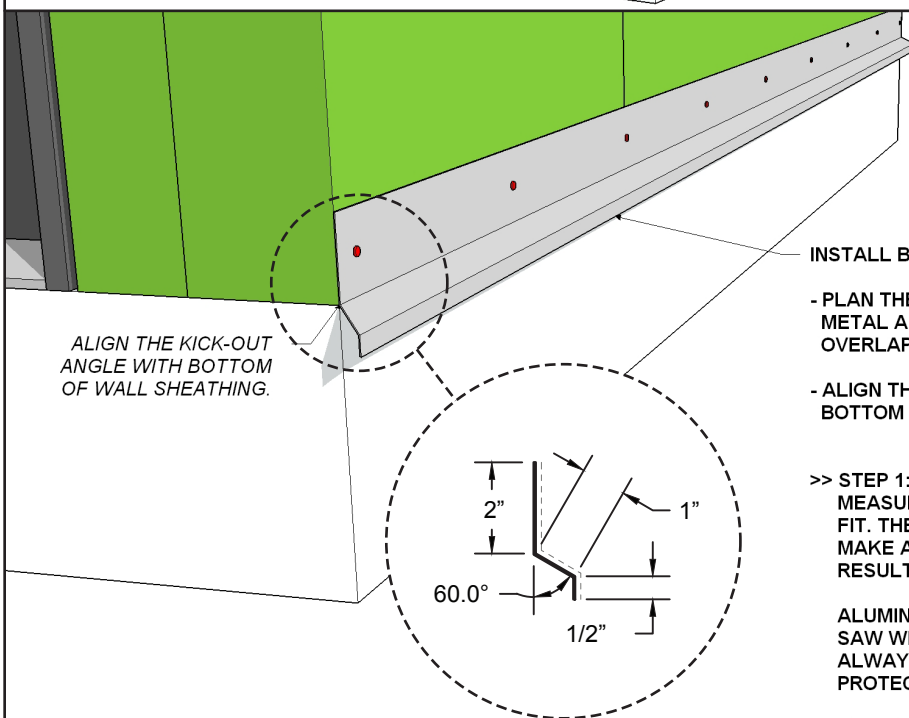

INSTALL BASE DRIP EDGE (TRIM PROFILE 'C'):

- PLAN THE SPLICE LOCATIONS, IF MULTIPLE PIECES OF METAL ARE USED, IN THE LEAST VISIBLE LOCATIONS. OVERLAP THE METAL 2-3".

- ALIGN THE KICK-OUT ANGLE OF THE FLASHING WITH THE BOTTOM OF THE WALL SHEATHING.

>> STEP 1:
MEASURE THE BUILDING WALL AND CUT THE TRIM TO FIT. THE DRIP EDGE MEETS UP AT BUILDING CORNERS. MAKE ALL CORNER CUTS 45° MITER CUTS FOR BEST RESULTS.

ALUMINUM CAN BE CUT USING A HACKSAW OR CHOP SAW WITH A HIGH TOOTH COUNT CARBIDE BLADE. ALWAYS WEAR THE APPROPRIATE EYE AND EAR PROTECTION!

>> STEP 2:
USE A PNEUMATIC BRAD NAILER, WITH 3/4" GALVANIZED BRAD NAILS, TO SECURE THE DRIP EDGE TO THE SHED. NAIL ~12" ON CENTER ALONG VERTICAL LEG OF DRIP EDGE. USE A CARPENTER'S LEVEL TO ENSURE DRIP EDGE REMAINS LEVEL DURING INSTALLATION.

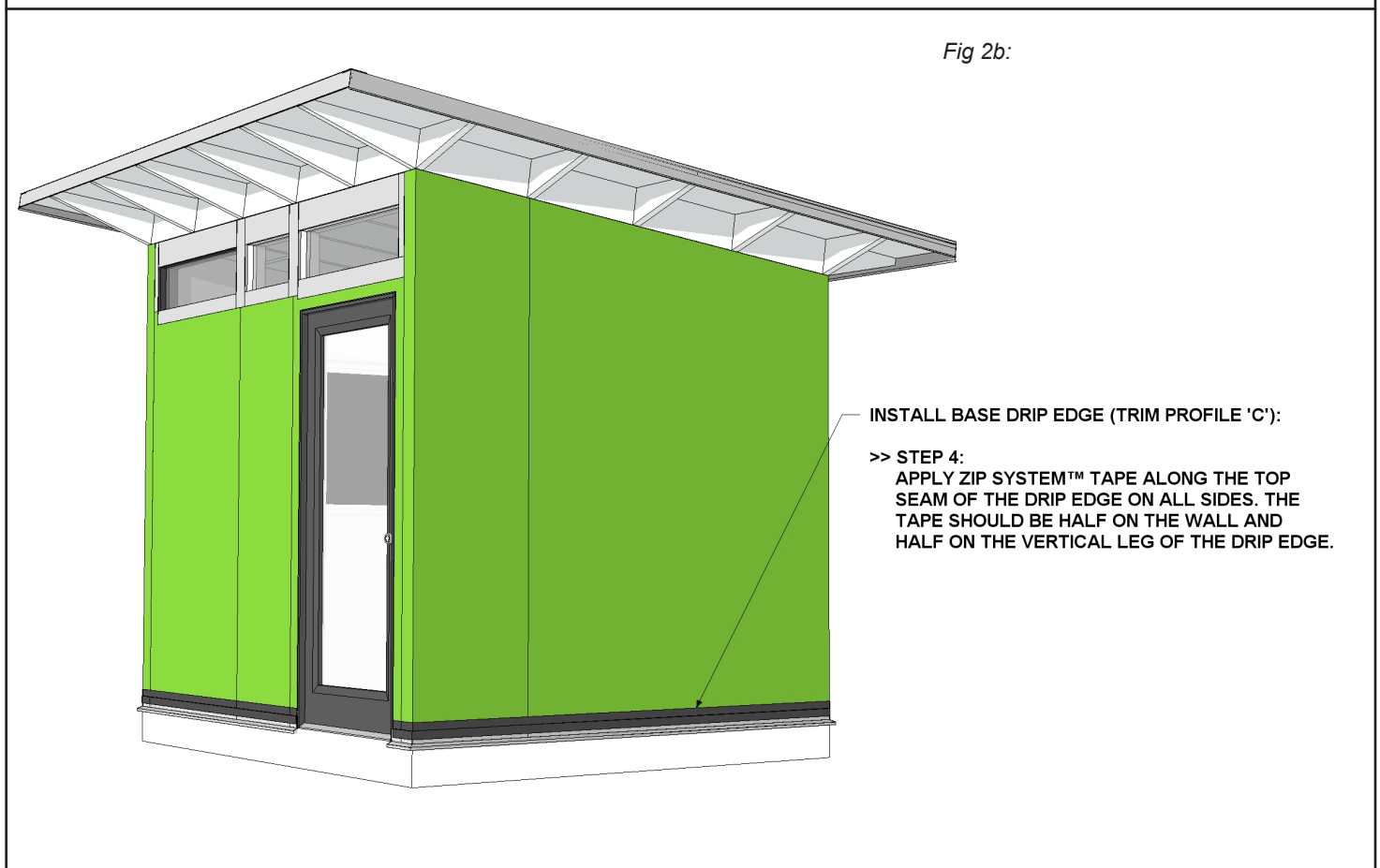
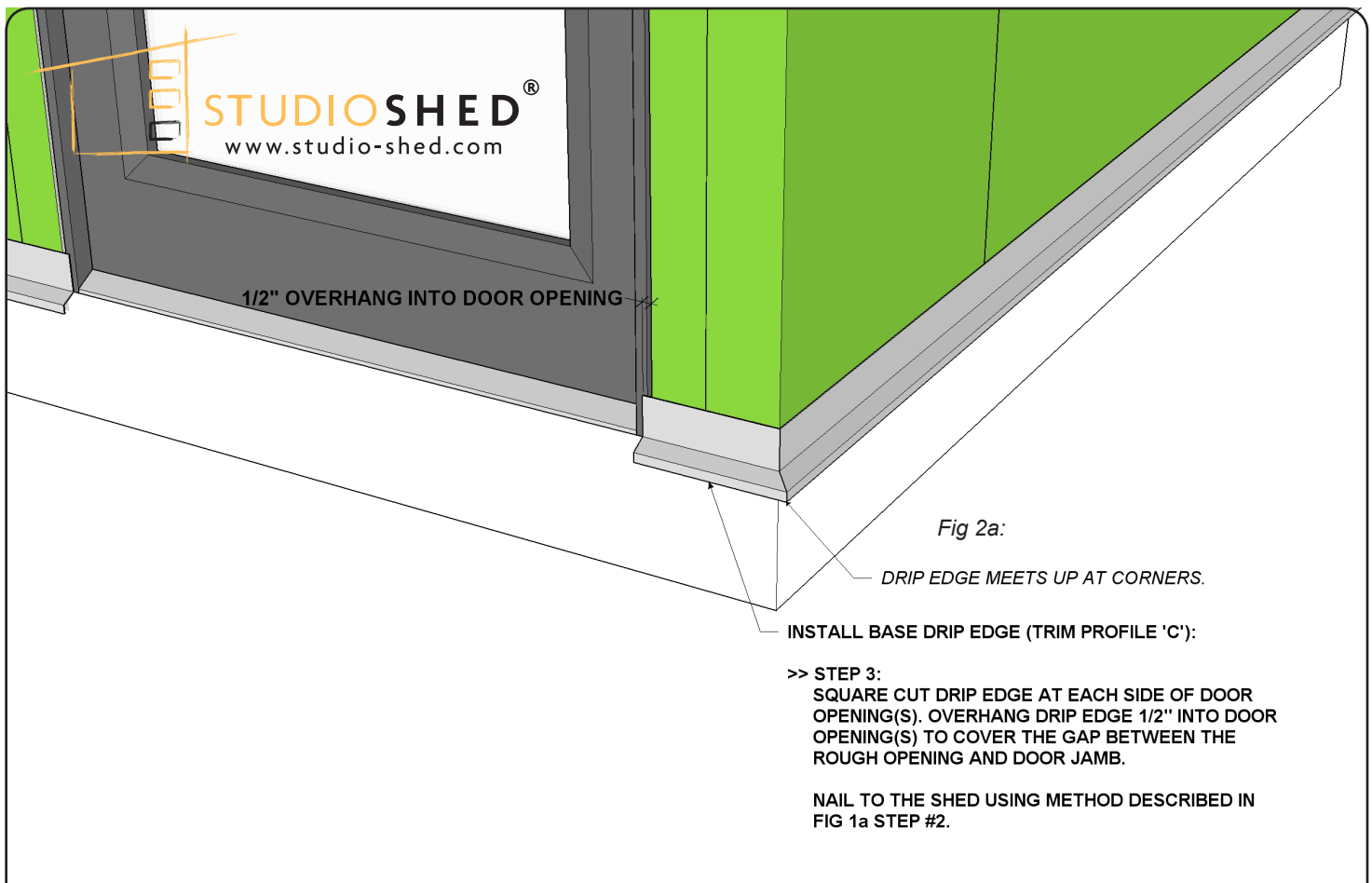

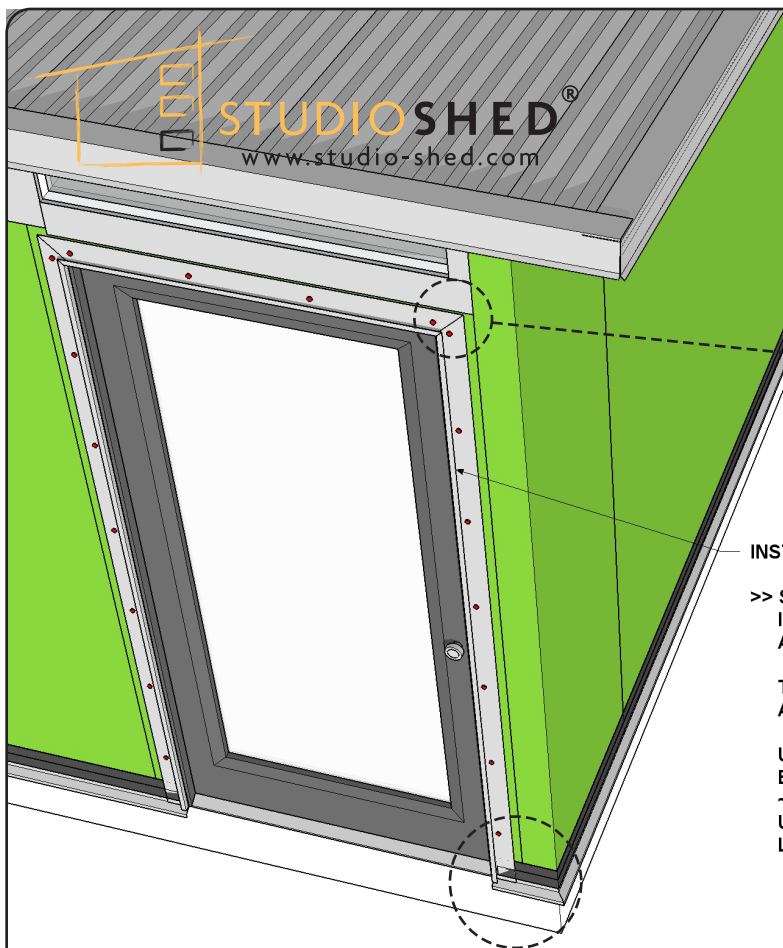
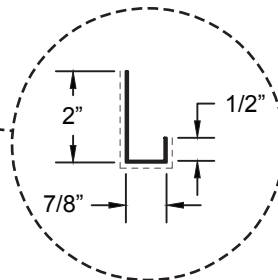

Fig 3a:



INSTALL DOOR CASING (TRIM PROFILE 'O'):

>> STEP 1:
INSTALL PRE-CUT DOOR CASING J-CHANNEL (PROFILE 'O')
AROUND DOOR OPENING.

TRIM WILL EXTEND 1/2" INTO ROUGH DOOR OPENING
AND WILL OVERLAP DOOR JAMB ~1/4" ALL AROUND.

USE A PNEUMATIC BRAD NAILER, WITH 3/4" GALVANIZED
BRAD NAILS, TO SECURE THE TRIM TO THE SHED. NAIL
~12" ON CENTER ALONG THE LONG LEG OF THE CASING.
USE A CARPENTER'S LEVEL TO ENSURE TRIM REMAINS
LEVEL DURING INSTALLATION.

Fig 3b:

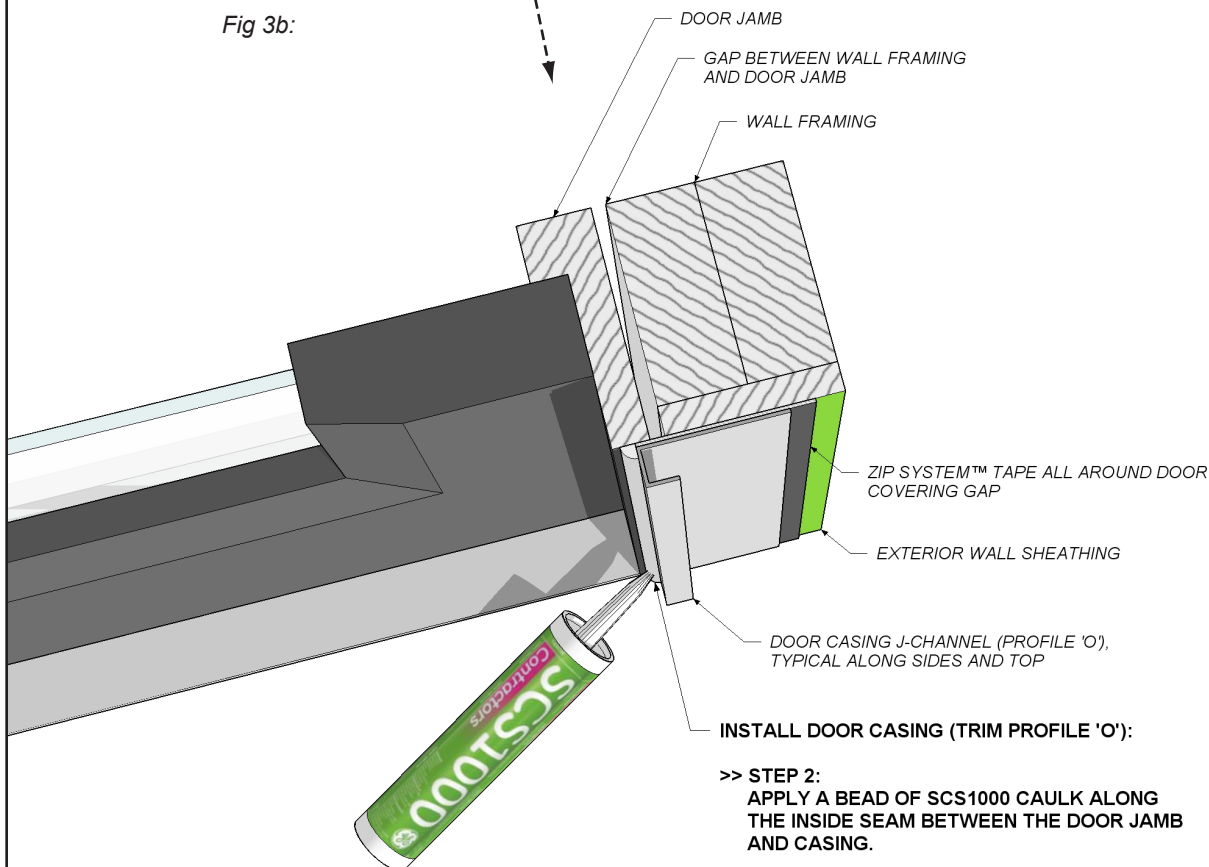

INSTALL DOOR CASING (TRIM PROFILE 'O'):

>> STEP 2:
APPLY A BEAD OF SCS1000 CAULK ALONG
THE INSIDE SEAM BETWEEN THE DOOR JAMB
AND CASING.

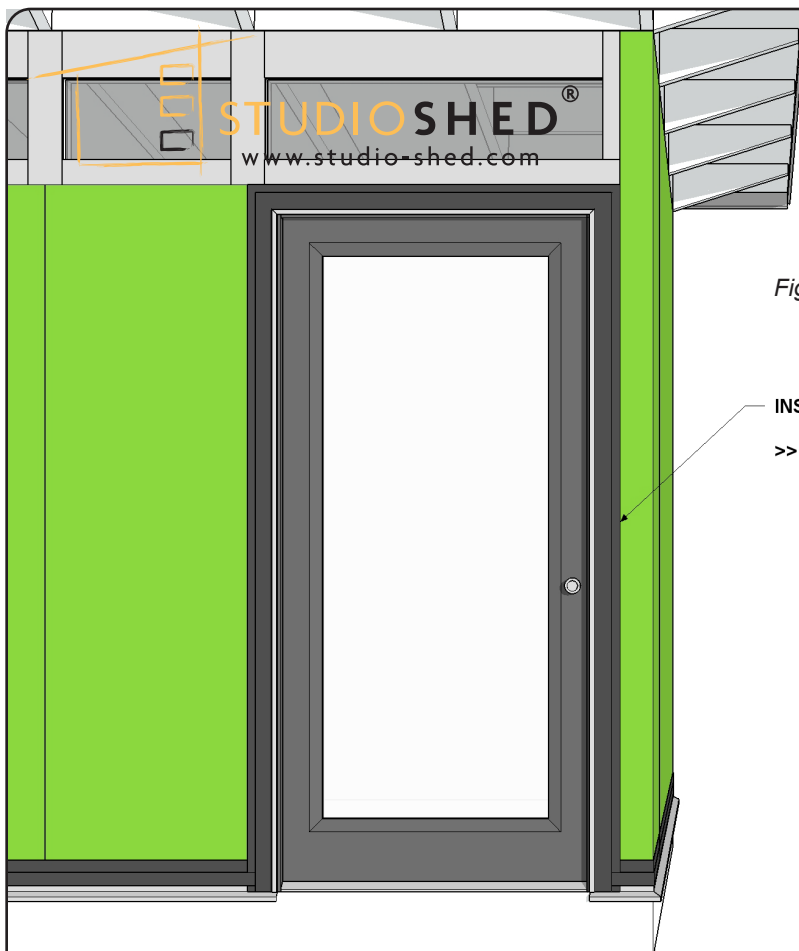

Fig 4a:

INSTALL DOOR CASING (TRIM PROFILE 'O'):

>> STEP 3:
FOR ADDITIONAL WEATHER PROTECTION, APPLY ZIP
SYSTEM TAPE AROUND THE ENTIRE PERIMETER OF THE
DOOR CASING. COVER THE ENTIRE LONG LEG OF THE
METAL CASING. THIS WILL LEAVE ~1 3/4" OF TAPE THAT
WILL BE APPLIED TO THE SHED.

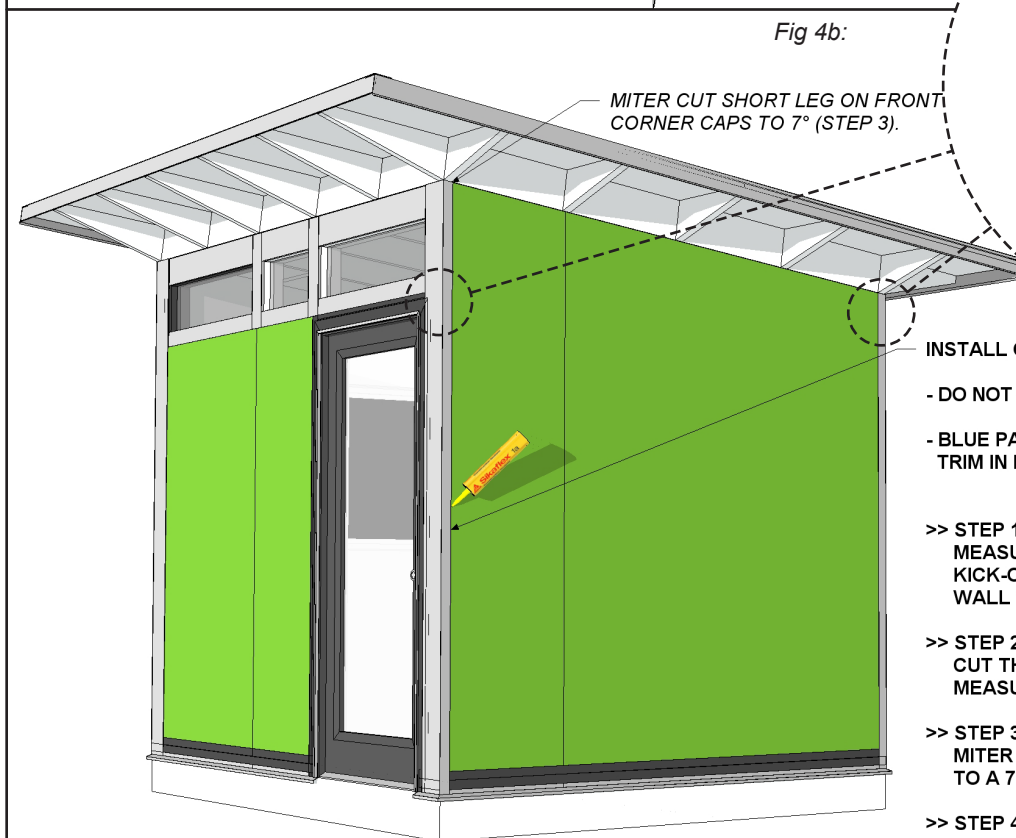

Fig 4b:

MITER CUT SHORT LEG ON FRONT
CORNER CAPS TO 7° (STEP 3).

PROFILE 'B' - 2x4 FRAMING
PROFILE 'H' - 2x6 FRAMING

INSTALL CORNER CAPS (TRIM PROFILE 'B' OR 'H'):

- DO NOT USE NAILS TO SECURE!
- BLUE PAINTERS TAPE MAY BE USED TO HOLD THE
TRIM IN PLACE WHILE THE ADHESIVE DRIES.

- >> STEP 1:
MEASURE EACH CORNER FROM THE TOP OF THE
KICK-OUT ON THE DRIP EDGE TO THE TOP OF THE
WALL SHEATHING.
- >> STEP 2:
CUT THE FOUR CORNER CAPS TO THE LENGTHS
MEASURED DURING STEP 1.
- >> STEP 3:
MITER CUT SHORT LEG, ON FRONT CORNER CAPS,
TO A 7° ANGLE TO MATCH THE ROOF SLOPE.
- >> STEP 4:
ADHERE THE CORNER CAP TO THE SHED BY
APPLYING SIKAFLEX ADHESIVE TO THE BACKSIDE
OF THE METAL. THE SHORT LEG OF THE TRIM
WILL BE ON THE SIDE WALLS.

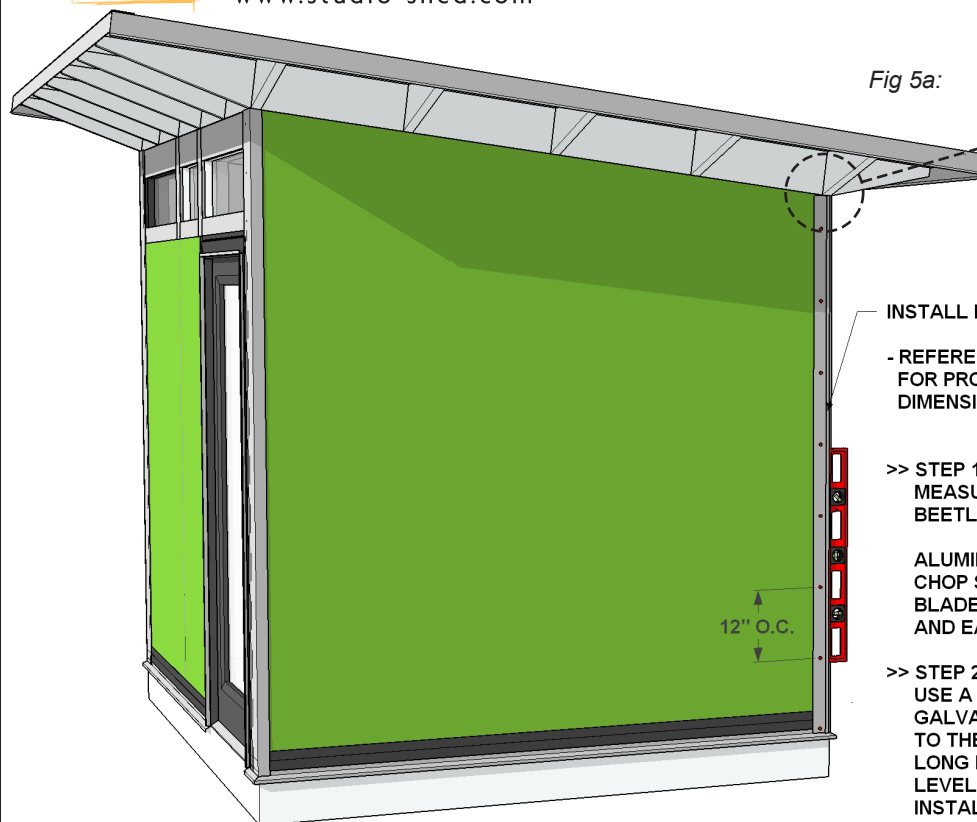
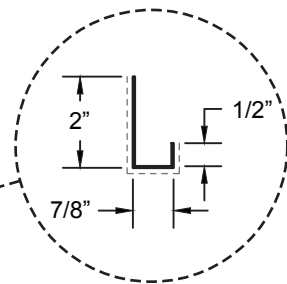

Fig 5a:



INSTALL BEETLE KILL SIDING:

- REFERENCE PROJECT INSTALLATION DRAWINGS FOR PROJECT SPECIFIC SIDING LAYOUT AND DIMENSIONS.

>> STEP 1:
MEASURE AND CUT ONE VERTICAL PIECE OF BEETLE KILL SIDING J-CHANNEL (PROFILE 'O').

ALUMINUM CAN BE CUT USING A HACKSAW OR CHOP SAW WITH A HIGH TOOTH COUNT CARBIDE BLADE. ALWAYS WEAR THE APPROPRIATE EYE AND EAR PROTECTION!

>> STEP 2:
USE A PNEUMATIC BRAD NAILER, WITH 3/4" GALVANIZED BRAD NAILS, TO SECURE THE TRIM TO THE SHED. NAIL ~12" ON CENTER ALONG THE LONG LEG OF THE TRIM. USE A CARPENTER'S LEVEL TO ENSURE TRIM REMAINS LEVEL DURING INSTALLATION.

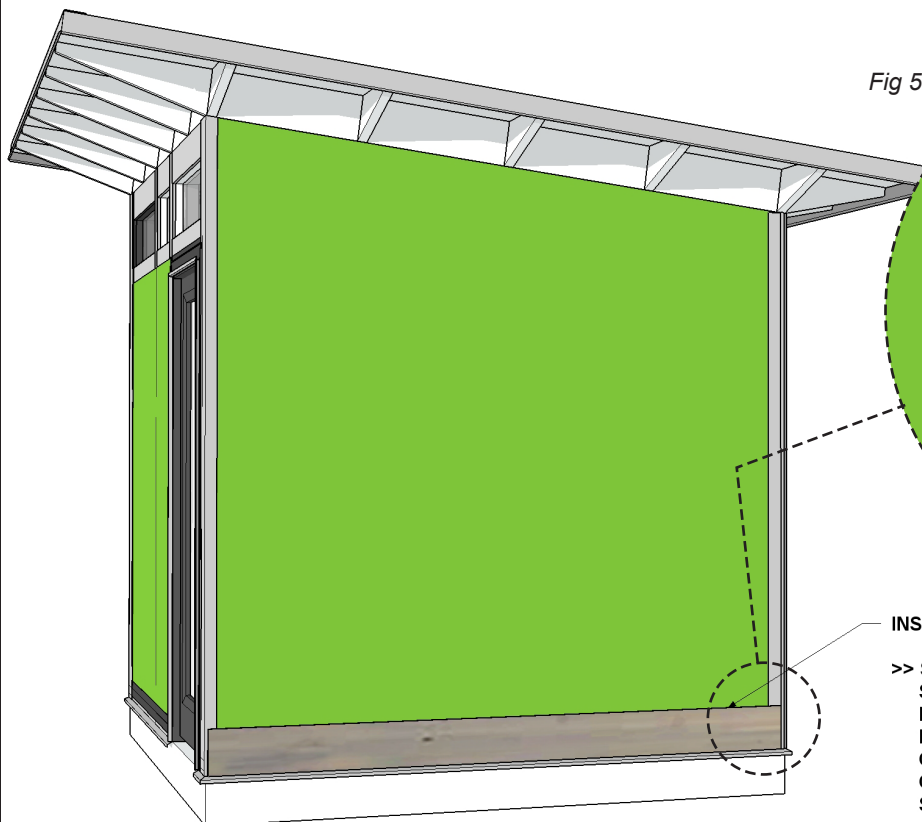

Fig 5b:

INSTALL BEETLE KILL SIDING:

>> STEP 3:
SLIDE BOTTOM PIECE OF SIDING INTO BEETLE KILL SIDING J-CHANNEL (PROFILE 'O'). THE BOTTOM EDGE OF THE SIDING WILL SIT ON TOP OF THE DRIP EDGE WHERE THE DRIP EDGE KICKS OUT. THIS IS ALSO THE BOTTOM OF THE WALL SHEATHING.

USE A CHOP SAW IF THE SIDING NEEDS TO BE CUT.

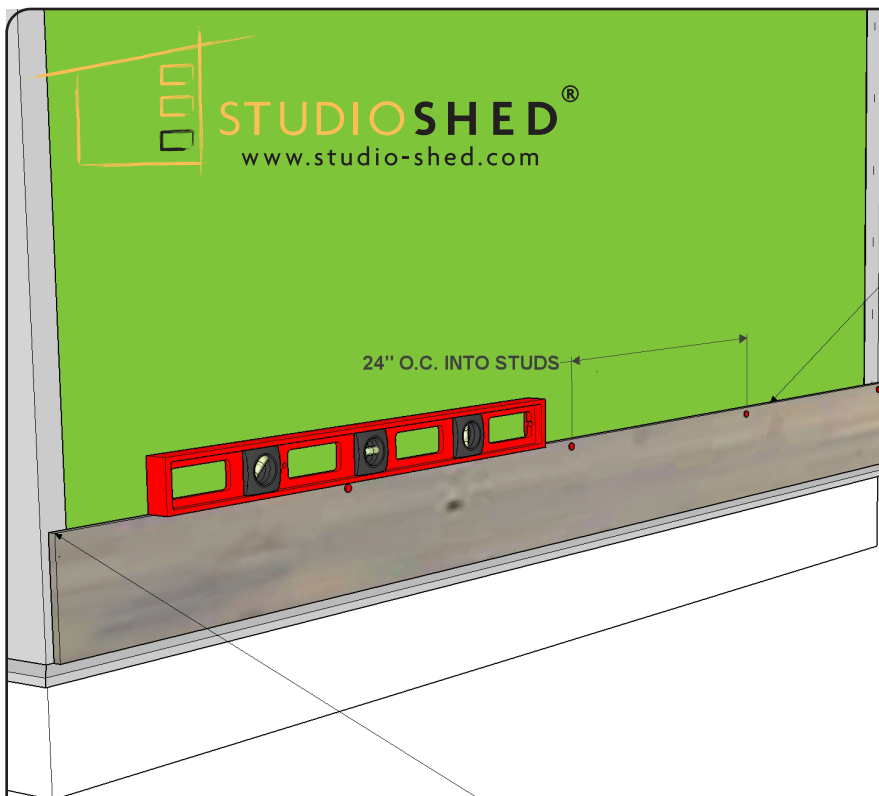

Fig 6a:

INSTALL BEETLE KILL SIDING:

- USE A CARPENTER'S LEVEL TO ENSURE THE SIDING REMAINS LEVEL DURING INSTALLATION.
- DO NOT NAIL CORNER OPPOSITE FROM TRIM PROFILE 'O' INSTALLED DURING FIG 5a. THIS WILL BE DONE LATER.

>> STEP 4:

USE A PNEUMATIC NAILER, WITH GALVANIZED #13 x 2" FINISH NAILS, TO SECURE THE TOP OF THE SIDING TO THE SHED.

NAIL ~3/8" DOWN FROM THE TOP EDGE AND ~24" ON CENTER INTO THE WALL STUDS. USE CARE TO MINIMIZE DAMAGE TO THE SIDING.

SINK NAIL HEADS ~1/16". FOR THE BEST LOOK, WOOD FILLER (NOT PROVIDED) CAN BE USED TO COVER THE HOLES.

DO NOT NAIL THIS CORNER!

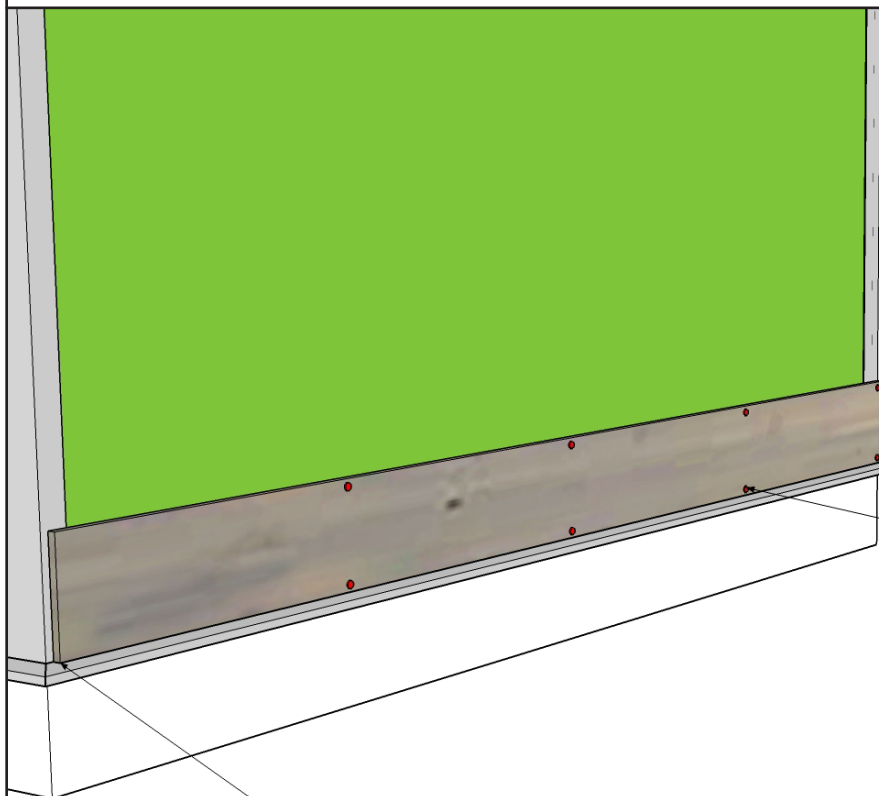

Fig 6b:

INSTALL BEETLE KILL SIDING:

- DO NOT NAIL CORNER OPPOSITE FROM BEETLE KILL SIDING J-CHANNEL (PROFILE 'O') INSTALLED DURING FIG 5a. THIS WILL BE DONE LATER.

>> STEP 5:

USE A PNEUMATIC NAILER, WITH GALVANIZED #13 x 2" FINISH NAILS, TO SECURE THE BOTTOM OF THE SIDING TO THE SHED.

NAIL ~3/8" UP FROM THE BOTTOM EDGE AND ~24" ON CENTER INTO THE WALL STUDS. USE CARE TO MINIMIZE DAMAGE TO THE SIDING.

SINK NAIL HEADS ~1/16". FOR THE BEST LOOK, WOOD FILLER (NOT PROVIDED) CAN BE USED TO COVER THE HOLES.

DO NOT NAIL THIS CORNER!

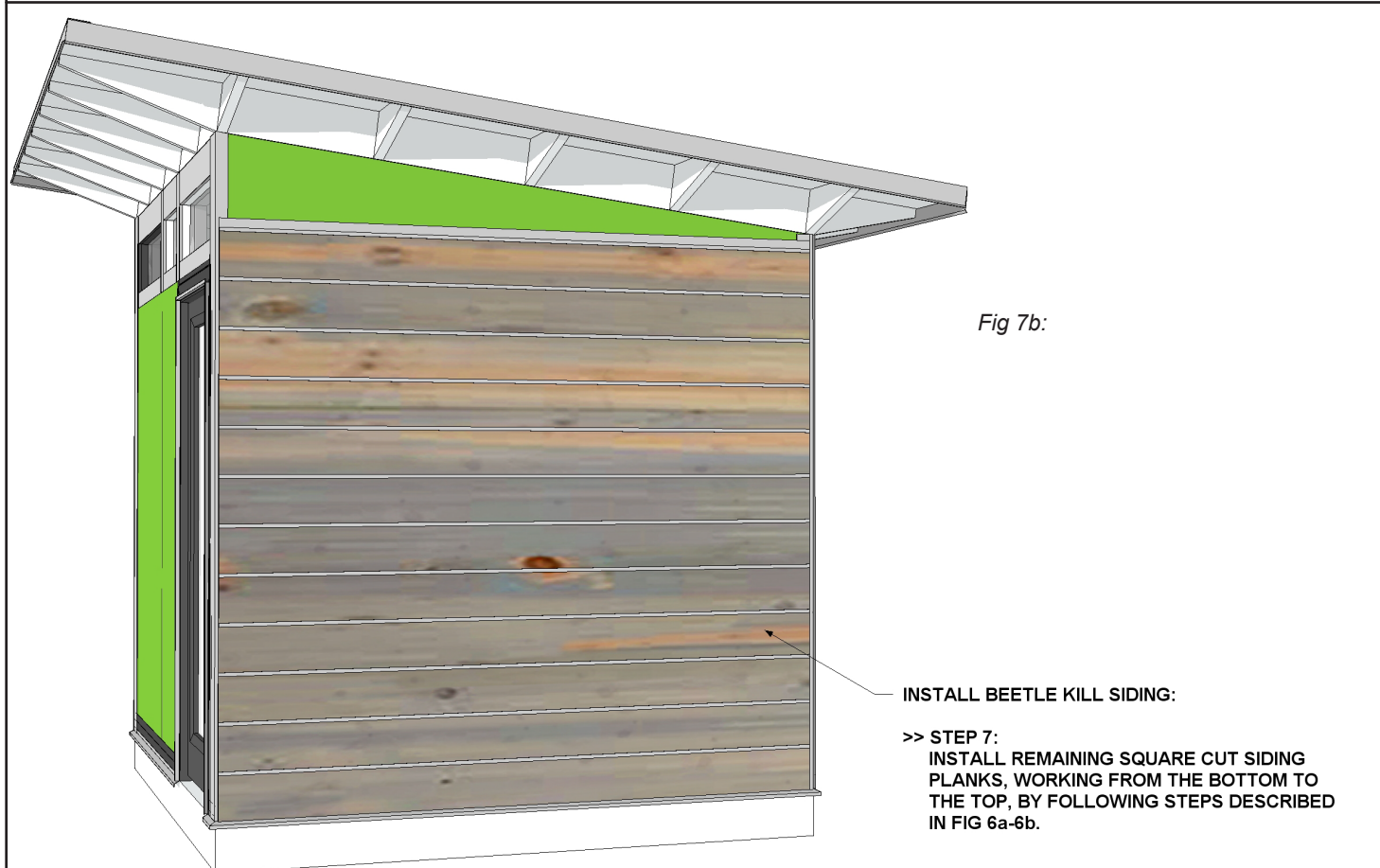
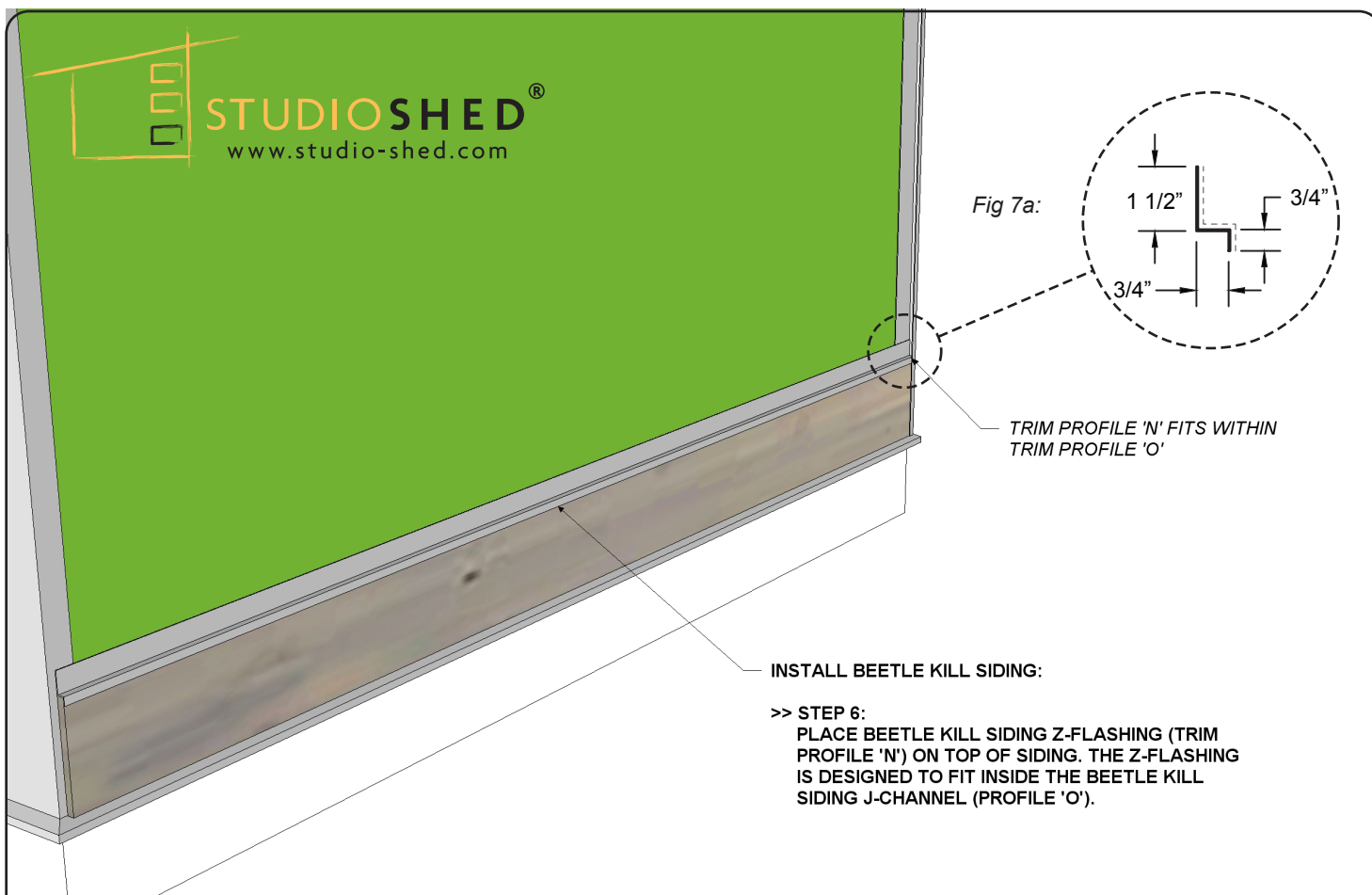
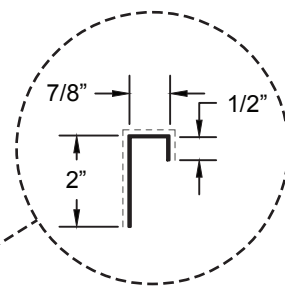



Fig 8a:



INSTALL BEETLE KILL SIDING:

>> STEP 8:

MEASURE ALONG THE TOP OF THE SHED AND CUT A PIECE OF BEETLE KILL SIDING J-CHANNEL (TRIM PROFILE 'O') TO FIT.

FOR BEST FIT, AT SIDE WALLS, THE FRONT EDGE WILL NEED TO BE MITER CUT 7°.

ALUMINUM CAN BE CUT USING A HACKSAW OR CHOP SAW WITH A HIGH TOOTH COUNT CARBIDE BLADE. ALWAYS WEAR THE APPROPRIATE EYE AND EAR PROTECTION!

>> STEP 9:

USING A PNEUMATIC BRAD NAILER, WITH 3/4" GALVANIZED BRAD NAILS, SECURE THE TRIM TO THE SHED. NAIL ~12" ON CENTER ALONG LONG LEG OF DRIP EDGE.

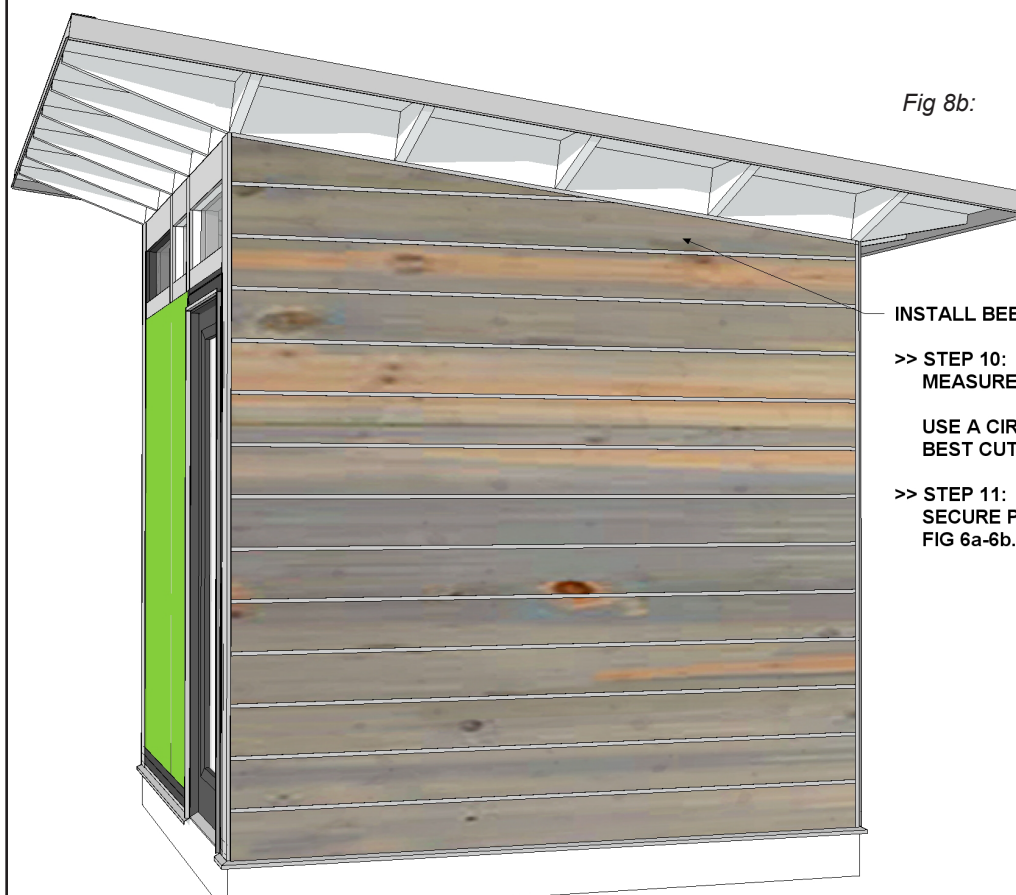

Fig 8b:

INSTALL BEETLE KILL SIDING:

>> STEP 10:

MEASURE AND TRIM TO FIT TOP SIDING PANELS.

USE A CIRCULAR SAW AND A GUIDE FOR THE BEST CUT.

>> STEP 11:

SECURE PANELS USING METHODS DESCRIBED IN FIG 6a-6b.

Fig 9a:

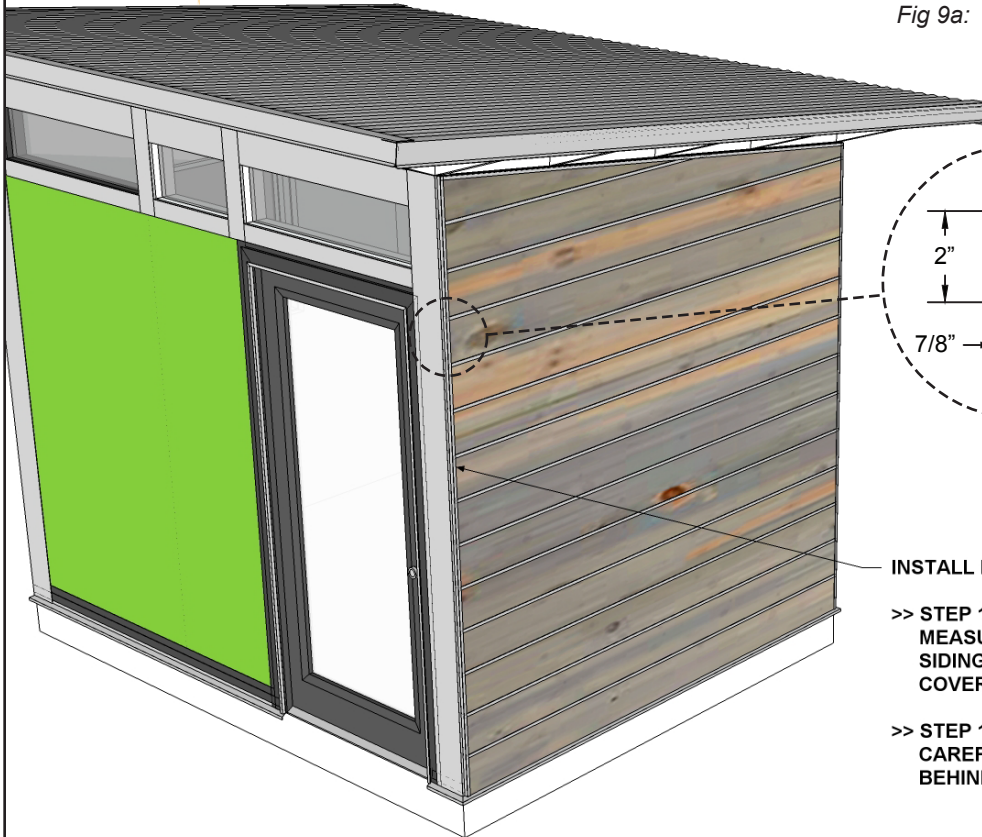

INSTALL BEETLE KILL SIDING:

>> STEP 11:
MEASURE AND CUT TO FIT BEETLE KILL
SIDING J-CHANNEL (TRIM PROFILE 'O') TO
COVER EXPOSED EDGE OF SIDING.

>> STEP 12:
CAREFULLY SLIDE TRIM NAILING FLANGE
BEHIND THE SIDING UNTIL IT IS SNUG.

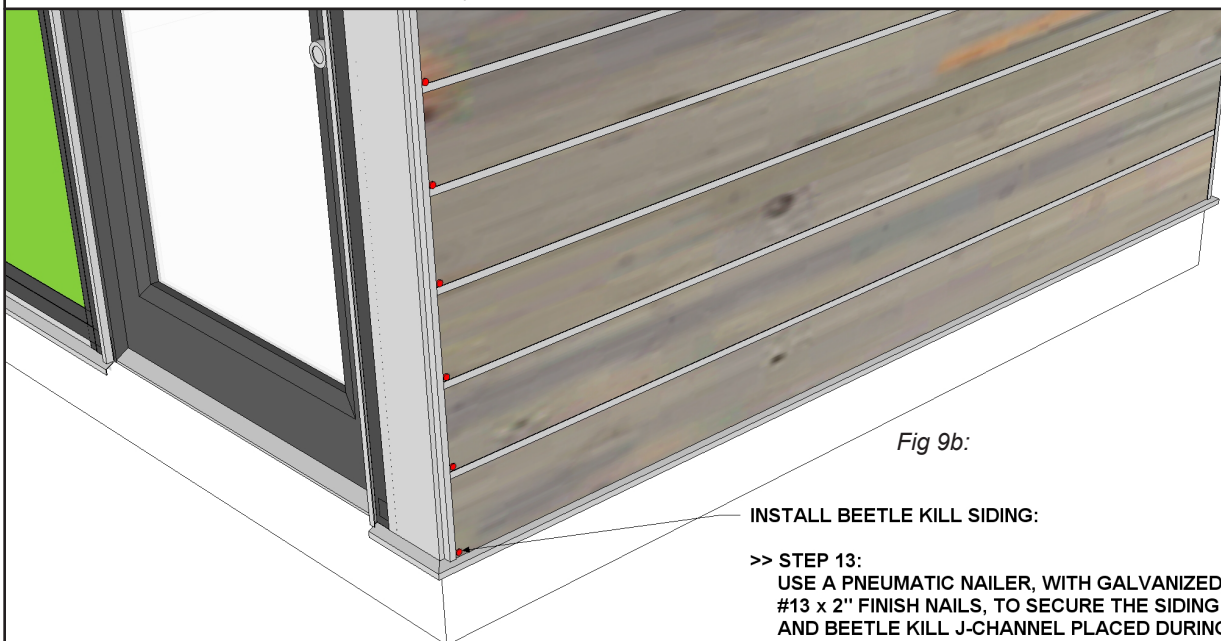

Fig 9b:

INSTALL BEETLE KILL SIDING:

>> STEP 13:
USE A PNEUMATIC NAILER, WITH GALVANIZED
#13 x 2" FINISH NAILS, TO SECURE THE SIDING
AND BEETLE KILL J-CHANNEL PLACED DURING
FIG 9a.

NAIL ~3/8" UP FROM THE BOTTOM EDGE OF
EACH SIDING PLANK. PLACE NAIL AS CLOSE TO
J-CHANNEL AS POSSIBLE. USE CARE TO MINIMIZE
DAMAGE TO THE SIDING.

SINK NAIL HEADS ~1/16". FOR THE BEST LOOK,
WOOD FILLER (NOT PROVIDED) CAN BE USED TO
COVER THE HOLES.

Fig 10a:



INSTALL BEETLE KILL SIDING (AROUND DOORS):

- REFERENCE PROJECT INSTALLATION DRAWINGS FOR PROJECT SPECIFIC SIDING LAYOUT AND DIMENSIONS.

>> STEP 1:
INSTALL SIDING PLANKS AROUND THE DOOR(S) BY WORKING FROM THE BOTTOM AND OUT FROM THE DOOR CASING. FOLLOW THE STEPS, IN THIS GUIDE, OUTLINED IN FIG 6a-9b.

FOLLOW THESE RULES BASED ON SHED TYPE AND SIDE:

SIGNATURE SERIES SHED FRONT WALL - STOP AT THE TOP OF THE DOOR BEFORE CONTINUING TO STEP 2.

SUMMIT SERIES SHED FRONT WALLS - INSTALL SIDING UP TO THE ROOF. REFERENCE FIG 8a-9b FOR METAL FLASHING DETAILS AT THE TOP OF WALLS.

SIGNATURE AND SUMMIT SERIES SHED SIDE AND BACK WALLS - INSTALL SIDING UP TO THE ROOF. REFERENCE FIG 8a-9b FOR METAL FLASHING DETAILS AT THE TOP OF WALLS.

DO NOT NAIL SIDING OR FLASHING ALONG EDGE CLOSEST TO BUILDING CORNER!

DO NOT NAIL SIDING OR FLASHING ALONG EDGE CLOSEST TO BUILDING CORNER!

Fig 10b:



DO NOT NAIL TOP OF SIDING PLANK.

INSTALL BEETLE KILL SIDING (AROUND DOORS):

>> STEP 2 (FRONT WALL SIGNATURE SERIES ONLY):
USE A CIRCULAR SAW OR TABLE SAW TO RIP DOWN THE SIDING PLANK TO THE SIZE LISTED IN THE SIDING INSTALLATION DRAWINGS.

>> STEP 3:
FOLLOW THE FASTENING SCHEDULE SHOWN IN FIG 6b TO ATTACH THE BOTTOM OF THE SIDING TO THE WALL.

DO NOT NAIL THE TOP EDGE OF THE SIDING. THIS WILL BE DONE LATER.

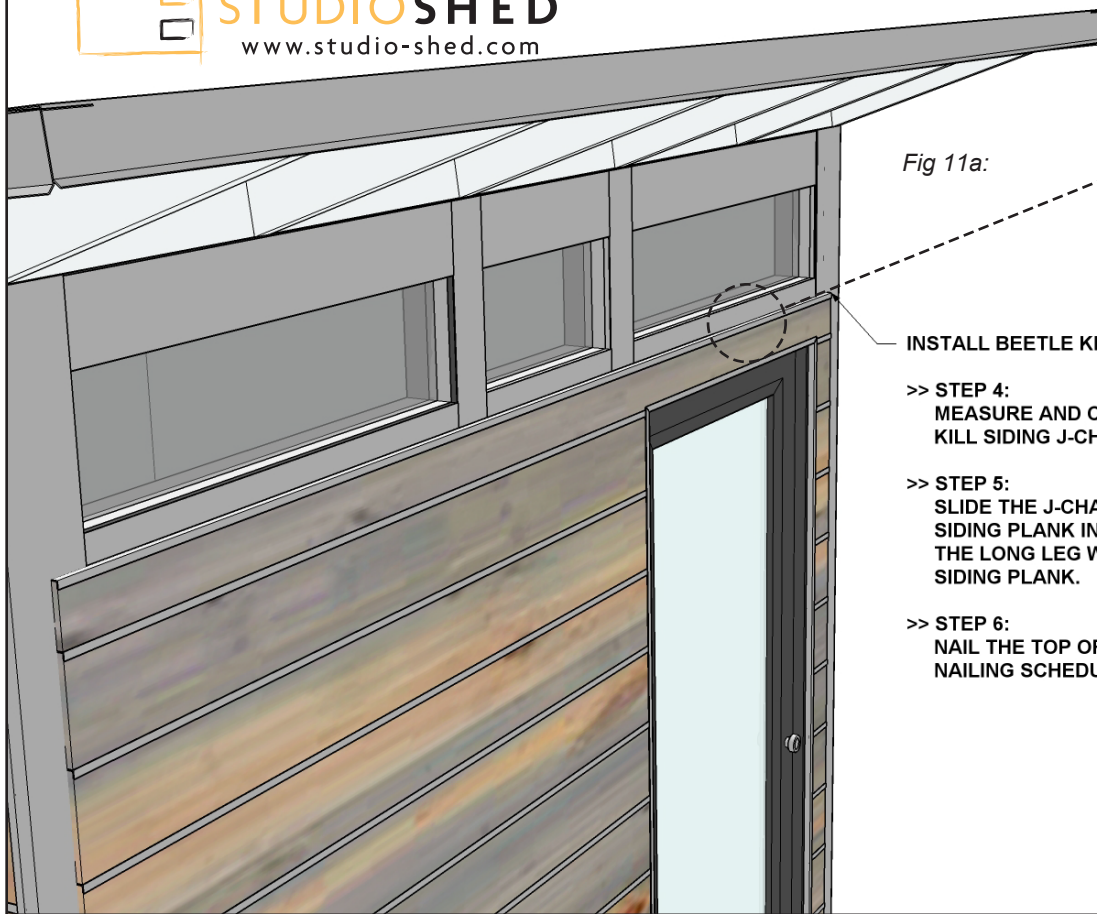
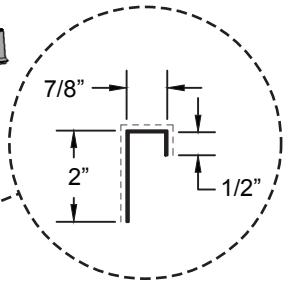

Fig 11a:



INSTALL BEETLE KILL SIDING (AROUND DOORS):

- >> STEP 4:
MEASURE AND CUT TO FIT A PIECE OF BEETLE KILL SIDING J-CHANNEL (PROFILE 'O').
- >> STEP 5:
SLIDE THE J-CHANNEL OVER THE TOP OF THE SIDING PLANK INSTALLED DURING FIG 10b. THE LONG LEG WILL FACE DOWN BEHIND THE SIDING PLANK.
- >> STEP 6:
NAIL THE TOP OF THE SIDING PLANK BY FOLLOWING NAILING SCHEDULE SHOWN DURING FIG 6a.

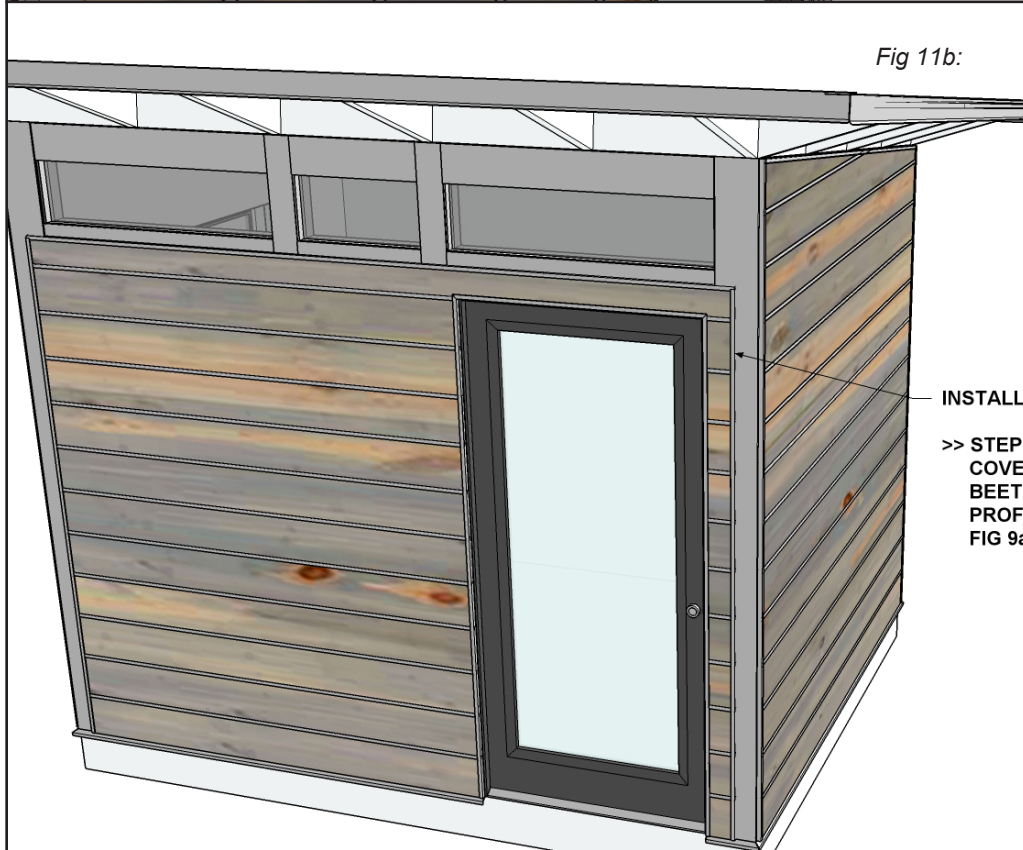

Fig 11b:

INSTALL BEETLE KILL SIDING (AROUND DOORS):

- >> STEP 7:
COVER EXPOSED EDGES OF SIDING WITH BEETLE KILL SIDING J-CHANNEL (TRIM PROFILE 'O'). FOLLOW STEPS DESCRIBED IN FIG 9a-9b.



Fig 12a:

WINDOW DRIP EDGE

INSTALL BEETLE KILL SIDING (AROUND WINDOWS):

- TO ENSURE BEST FIT, SIDING PANELS AROUND WINDOWS ARE SHIPPED UNCUT.

>> STEP 1:

MEASURE AND TRIM TO FIT SIDING PANELS AND BEETLE KILL SIDING Z-FLASHING (TRIM PROFILE 'N') AROUND WINDOWS. THE SIDING SHOULD COVER THE WINDOW NAILING FLANGE AND FIT TIGHT AGAINST THE WINDOW DRIP EDGE.

>> STEP 2:

FASTEN SIDING PANELS TO THE SHED BY FOLLOWING THE STEPS OUTLINED IN FIG 6a-7b.