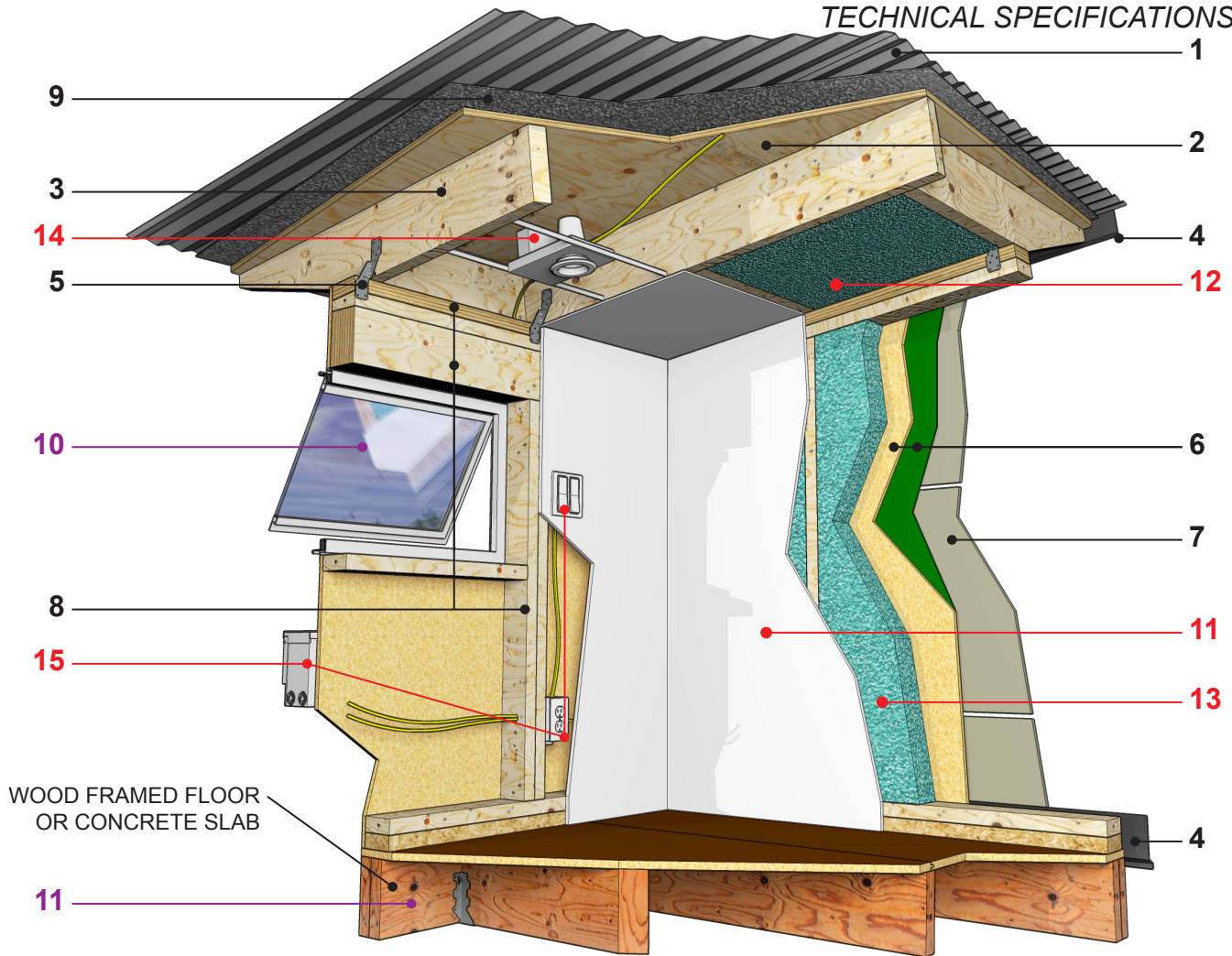

**TECHNICAL SPECIFICATIONS**

**STANDARD FEATURES:**

- 1) GALVALUME OR PAINTED CORRUGATED METAL ROOF
- 2) PLYWOOD ROOF SHEATHING
- 3) 2x RAFTERS AND BLOCKING
- 4) CUSTOM MANUFACTURED ALUMINUM FLASHING AND TRIM
- 5) SIMPSON STRONG-TIE® TIE-DOWNS AT ALL RAFTER CONNECTIONS
- 6) ZIP SYSTEM® WALL SHEATHING WITH INTERGRATED WATER-RESISTIVE BARRIER
- 7) FIBER CEMENT SIDING
- 8) FIR AND ENGINEERED WOOD WALL FRAMING
- 9) ROOFING FELT (BY INSTALLER OR CUSTOMER)

**OPTIONAL ADD-ONS:**

- 10) ENERGY EFFICIENT LOW-E OPERABLE WINDOWS
- 11) PRESSURE TREATED WOOD FRAMED FLOOR ON PIERS (AVAILABLE ON SELECT MODELS)

**LIFESTYLE PACKAGE:**

- 11) SEAMLESS DRYWALL INTERIOR
- 12) RECYCLED DENIM ROOF INSULATION
  - R-21 (2x6 RAFTERS)
  - R-30 (2x8 AND 2x10 RAFTERS)
- 13) RECYCLED DENIM WALL INSULATION
  - R-13
- 14) 3" INTERIOR RECESSED LIGHT FIXTURES
  - LED (600 LUMENS)
- 15) ELECTRICAL PACKAGE
  - EXTERIOR MOUNTED JUNCTION BOX WITH 15 AND 20 AMP BREAKERS
  - DUPLEX WALL OUTLET, DUPLEX GFCI OUTLET AND EXTERIOR DUPLEX OUTLET
  - LIGHT SWITCHES
  - EXTERIOR LIGHT FIXTURE(S)